

rev.	date	description

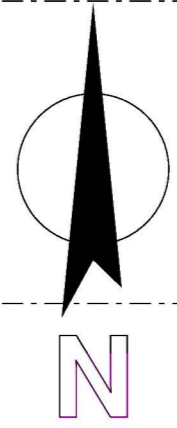
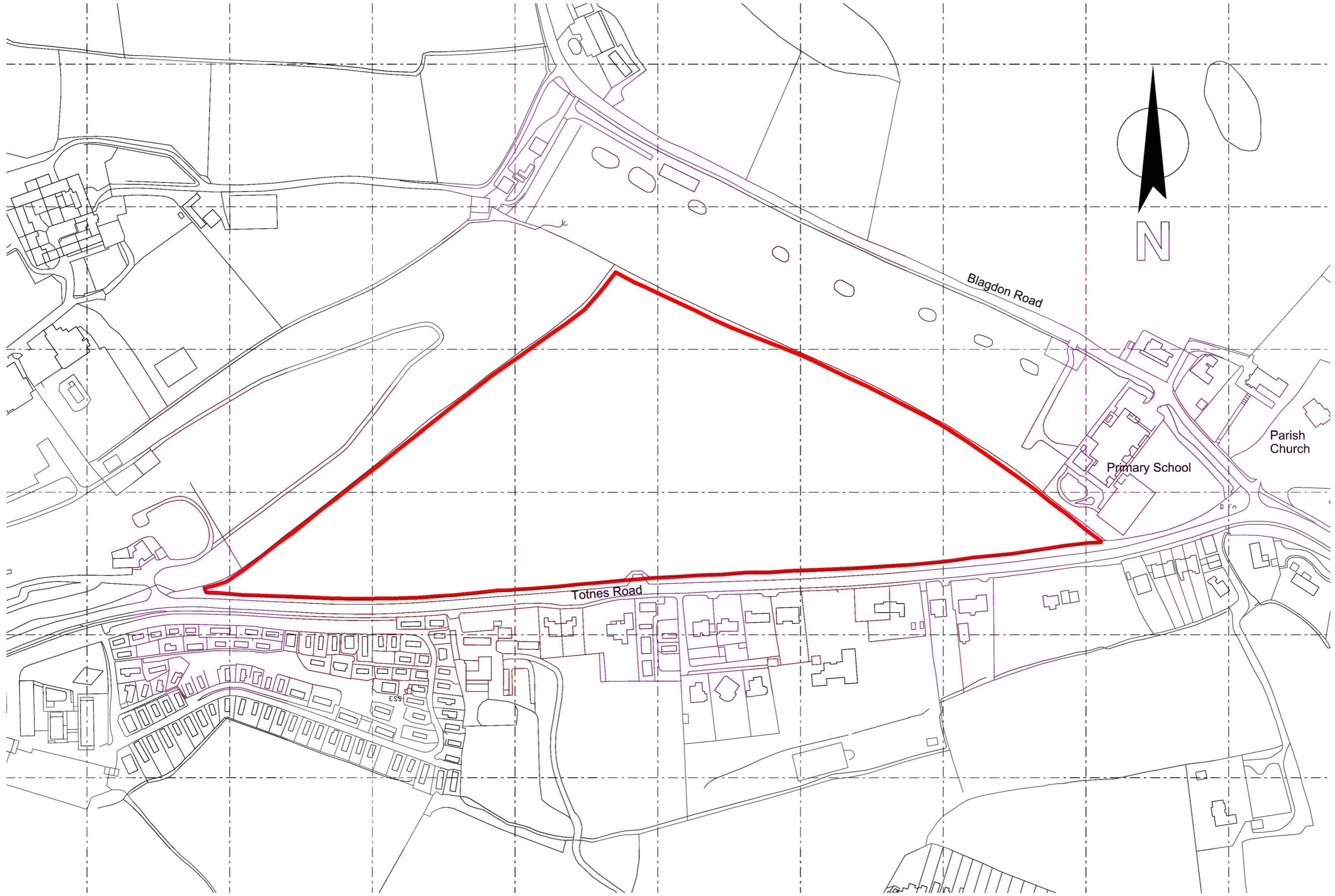

Blagdon Road

Primary School

Parish Church

Totnes Road

Drainage Survey, (c) Crown Copyright 2012. All rights reserved. Licence number 100020449

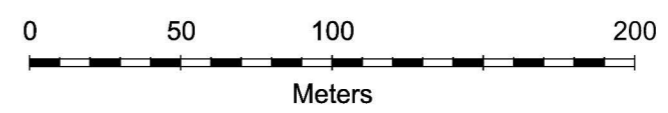

Roberts Limbrick
ARCHITECTS

project
 PROPOSED HOUSING
 DEVELOPMENT
 COLLATON ST. MARY
 DEVON

client
 TAYLOR WIMPEY

drawing
LOCATION PLAN
 -
 -
 -

status
PLANNING

ROBERTS LIMBRICK LTD
 The Carriage Building
 Bruton Way,
 Gloucester, GL1 1DG
 T. 03333 405 500
 F. 03333 408 920
 mail@robertslimbrick.com
 www.robertslimbrick.com

Registered Office: England No. 06658029

scale
 1/2500 @ A3

date 18/03/13 author

project drg no. rev.
6951 PL01 -