

(C) THIS DRAWING IS COPYRIGHT  
 CONTRACTORS MUST CHECK ALL DIMENSIONS ON SITE. ONLY FIGURED DIMENSIONS ARE TO BE WORKED FROM. DISCREPANCIES MUST BE REPORTED IMMEDIATELY TO A CONSULTING ENGINEERS LIMITED BEFORE PROCEEDING.  
 THE CONTRACTOR IS TO REFER TO THE SPECIFICATION FULL SCHEDULE OF RESIDUAL RISKS IN THE CONTRACT DOCUMENTATION AND ALSO TO INFORMATION FROM OTHER DESIGNERS, IN PARTICULAR THE MAIN CONSULTANT REGARDING EXISTING LINE SERVICES.  
 ALWAYS CHECK FOR LATER REVISIONS OF THIS DRAWING

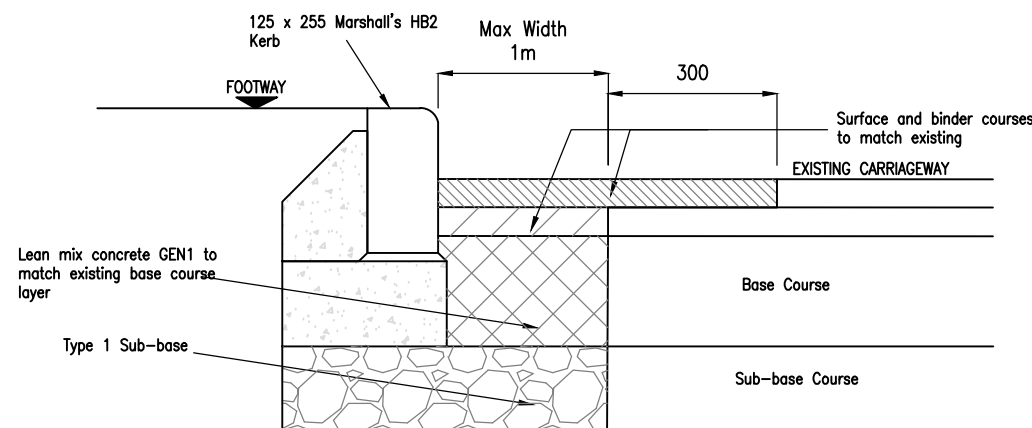

NARROW WIDTH CONSTRUCTION

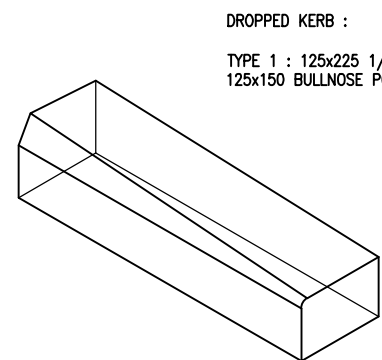

KERB DETAIL DL1/DR1 - DL2/DR2  
 (LEFT AND RIGHT HAND UNITS TO BE USED)  
 SCALE N.T.S

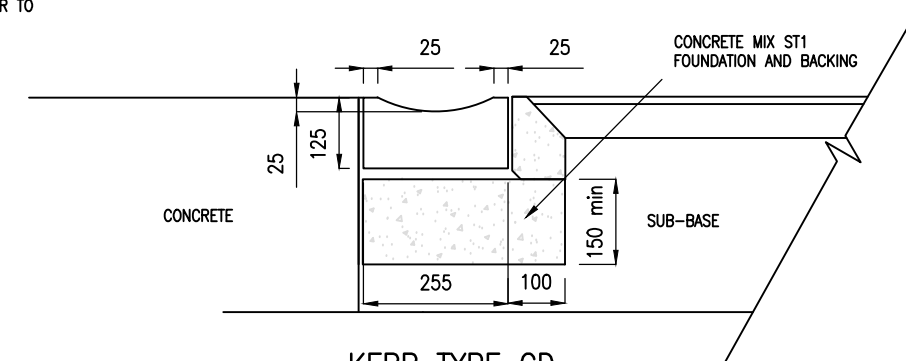

KERB TYPE CD

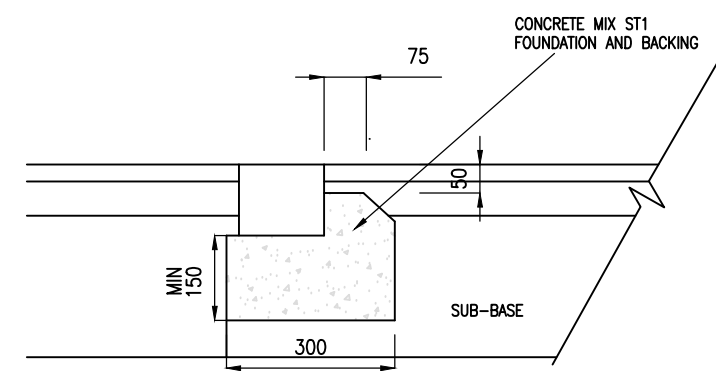

KERB TYPE CS2

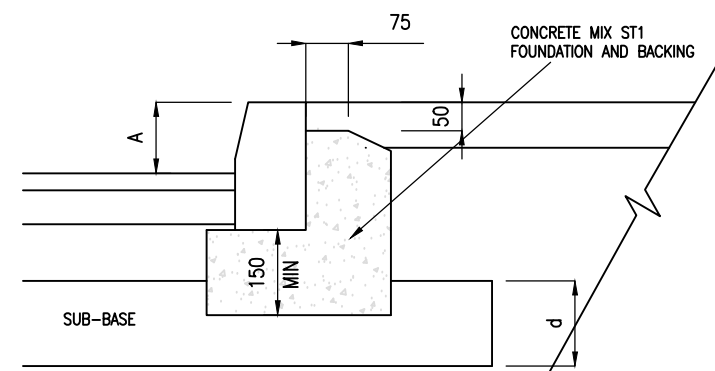

KERB TYPES HB2 & BN

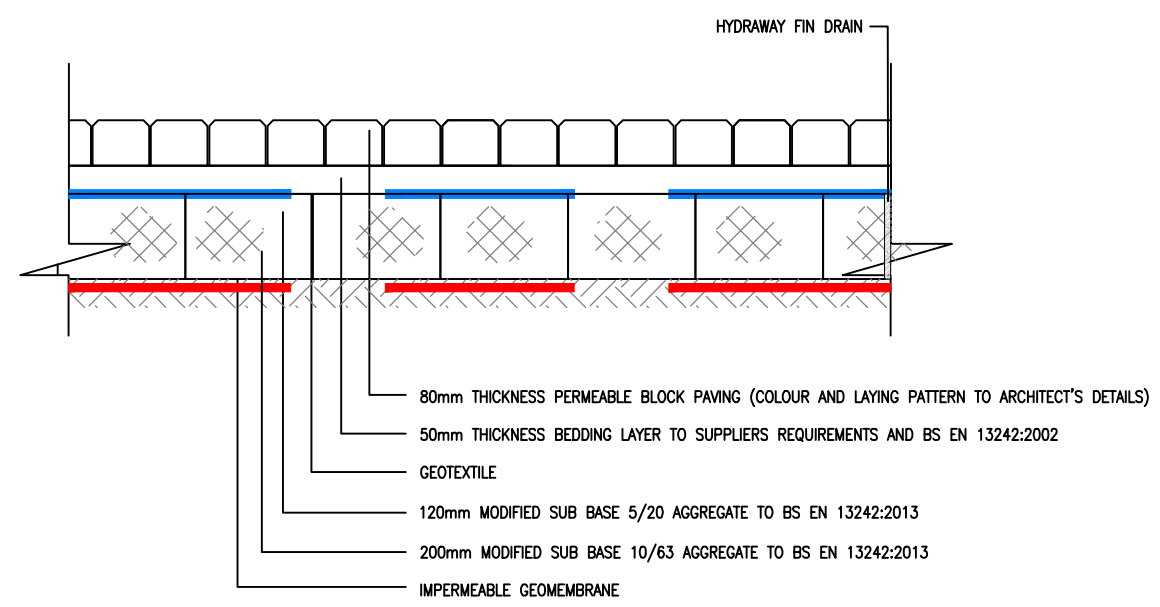

PERMEABLE PAVING CONSTRUCTION

Notes:  
 1. Permeable paving system to be Marshall's Piora or similar approved. Contractor to submit details of alternative schemes.

- KERBING NOTES
1. ALL DIMENSIONS ARE IN MILLIMETRES.
  2. PAVEMENT THICKNESSES SHOWN ARE TYPICAL ONLY.
  3. THE MORTAR BED SHALL COMPLY WITH CLAUSE 2404 AND MAY BE OMITTED PROVIDING THE KERBING IS LAID NOT LATER THAN 2 HOURS AFTER THE CONCRETE FOUNDATIONS AND THE CONCRETE IS STILL PLASTIC.
  4. CONCRETE KERB TYPES SHALL BE IN ACCORDANCE WITH BS EN 1340 NATIONAL ANNEX AND BE AS SPECIFIED IN THE CONTRACT. DIMENSION A=25 AT VEHICLE CROSSINGS OR A=0 AT PEDESTRIAN CROSSINGS WITH TACTILES AND 10mm WITHOUT TACTILES OR A=125mm ELSEWHERE, UNLESS SPECIFIED OTHERWISE.
  5. WHERE AN ACCESS IS REQUIRED ACROSS A GRANITE KERBED FOOTWAY THE DROPPED AREA MAY BE FORMED BY THE GRANITE KERB LAID ON ITS SIDE.
  6. APPROPRIATE TRANSITION KERBS MUST BE USED BETWEEN DIFFERENT KERB TYPES.
  7. ALL TIMBER SHALL BE IN ACCORDANCE WITH CL.304, SHW.
  8. TYPE TK KERB MAY ALSO BE OF THE NON DOWELLED TYPE.

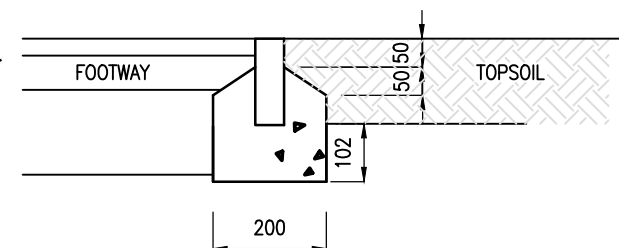

KERB TYPE EF

REV	DATE	DESCRIPTION	DR'N	CH'K
C	22.11.13	Narrow Width Construction and CD Kerb Added	AOH	DG
B	4.11.13	Drop Kerb detail added	AOH	DG
A	18.10.13	Preliminary Issue	AOH	DG

Issue Status

CONCEPT  CONSTRUCTION  
 PRELIMINARY  H&S FILE ISSUE  
 TENDER

Project  
**Preston Down Rd  
 Paignton**

Detail  
**Standard Highway Details**

Client/Architect  
**Galliford Try**

Scale @ A3  
**NTS**

Project Ref **B9902** Drawing No **702** Rev **C**

**Consulting Engineers Ltd**  
 CIVIL STRUCTURAL ENVIRONMENTAL  
 TRAFFIC HIGHWAYS GEOTECHNICAL

**BRISTOL**  
 TEL 0117 922 6286  
 FAX 0117 922 6813  
 EMAIL: BRISTOL@JJB.LK.COM

**FARNBOROUGH**  
 TEL 01252 551050  
 FAX 01252 551025  
 EMAIL: FARNBOROUGH@JJB.LK.COM

**CARDIFF**  
 TEL 029 2032 4444  
 FAX 029 2032 4445  
 EMAIL: CARDIFF@JJB.LK.COM

**PLYMOUTH**  
 TEL 01752 797000  
 FAX 01752 797001  
 EMAIL: PLYMOUTH@JJB.LK.COM