

Z:\9730_PAIGNTON_COASTAL_SCHEME_RIBA_4_8\7\CADDRAWINGS\CONSTRUCTION DRAWING SHEETS\9730_PAIGNTONFURNITURE.DWG

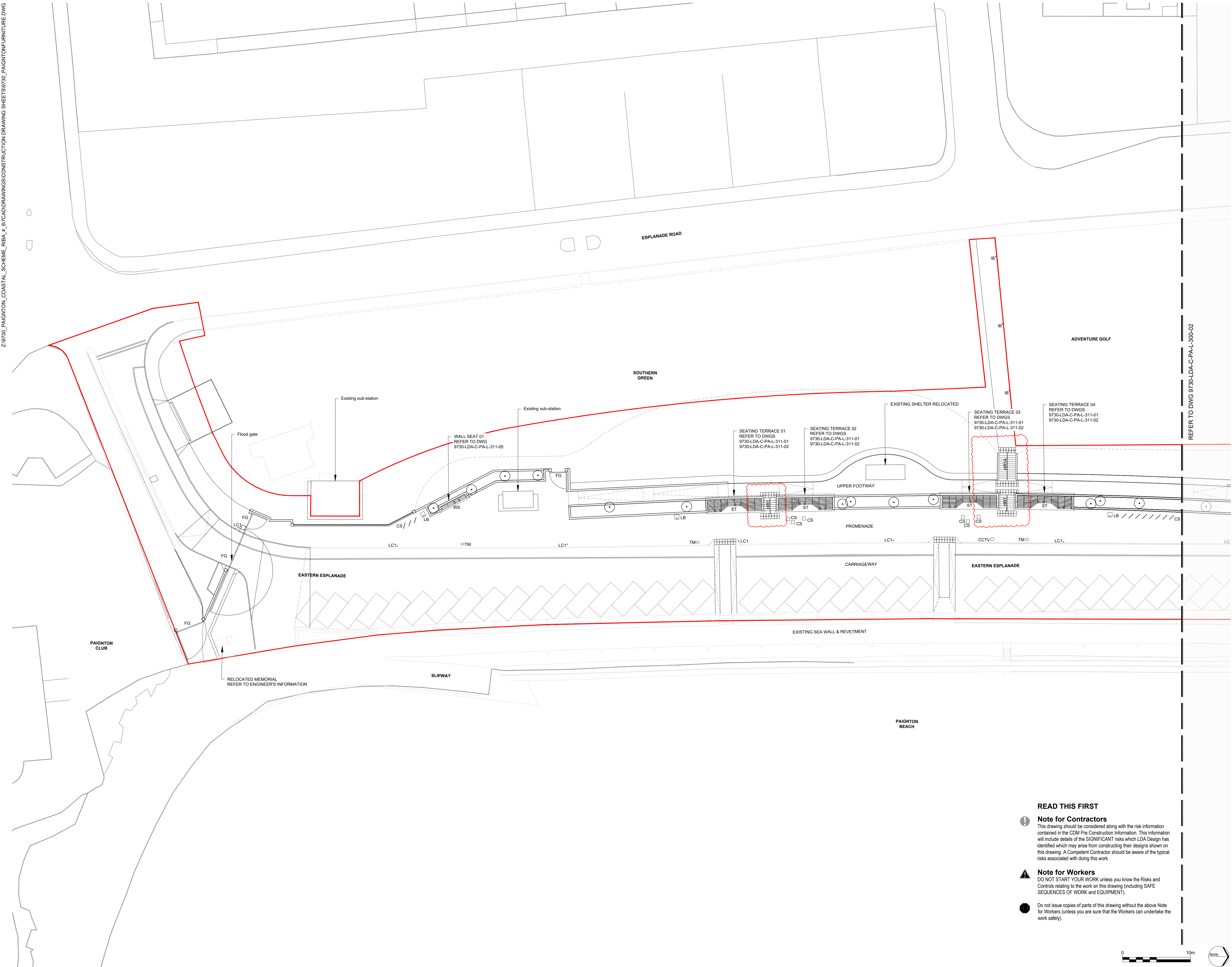

| LEGEND | |
|--------|---|
| | Scheme Boundary |
| | Light Column Type 1 Selux Olvio Sistema |
| | Light Column Type 1A Selux Olvio Sistema with Gobo projector |
| | Light Column Type 3 Highways Column Refer to Engineer's information |
| | Illuminated Bollard Selux Intra |
| | Sheffield Cycle Stand 316 Stainless Steel |
| | Bollard Type 1 316 Stainless Steel |
| | Bollard Type 1A (Folding) 316 Stainless Steel |
| | Big Belly Litter Bin (86L) |
| | Balustrade |
| | Handrail Type 1 (Step Mounted) |
| | Handrail Type 1A (Step Mounted) |
| | Handrail Type 2 (Wall Mounted) |
| | Handrail Type 2A (Wall Mounted With Landing) |
| | Handrail Type 2B (Wall Mounted With Landing) |
| | Timber Cube Seat |
| | Timber Seating Terrace |
| | Timber Wall Seat |
| | Timber Picnic Bench |
| | Flood Gate Refer to Engineer's Information |
| | Climbing Wall Refer to Landscape Specification |
| | Climbing Ropes Refer to Landscape Specification |
| | Climbing Holds Refer to Landscape Specification |
| | Stepping Stones Refer to Landscape Specification |
| | Slide Refer to Landscape Specification |
| | Ticket Machine |
| | CCTV columns |

- For Paignton Furniture and Lighting Layout and Reference Plans refer to DWGs 9730-LDA-C-PAL-300-01 to 9730-LDA-C-PAL-300-05
- For Preston Furniture and Lighting Layout and Reference Plans refer to DWGs 9730-LDA-C-PR-L-300-01 to 9730-LDA-C-PR-L-300-03
- For Paignton Balustrade and Handrail Details refer to DWGs 9730-LDA-C-PAL-310-01 to 9730-LDA-C-PAL-310-03 and 9730-LDA-C-PAL-310-05
- For Preston Balustrade and Handrail Details refer to DWGs 9730-LDA-C-PR-L-310-11 and 9730-LDA-C-PR-L-310-12
- For Paignton Seating Terrace Details refer to DWGs 9730-LDA-C-PAL-311-01 to 9730-LDA-C-PAL-311-04
- For Paignton Wall Seat Details refer to DWGs 9730-LDA-C-PAL-311-05- 9730-LDA-C-PAL-311-05 to 12
- For Paignton Arm Rest Detail refer to DWG 9730-LDA-C-PAL-311-20
- For Preston Wall Seat Details refer to DWGs 9730-LDA-C-PR-L-311-30 to 9730-LDA-C-PR-L-311-30
- For Preston Timber Bench and Preston Timber Platform Bench refer to 9730-LDA-C-PR-L-311-51
- Drawings to be read in conjunction with External Works Specification 9730-LDA-C-XX-L-900-01

NOTES:

1. THIS DRAWING IS TO BE READ IN CONJUNCTION WITH ALL OTHER DRAWINGS AND SPECIFICATIONS.
2. DO NOT SCALE OFF THIS DRAWING. WRITTEN DIMENSIONS TO BE TAKEN ONLY.
3. ANY DISCREPANCIES FOUND BETWEEN THIS DRAWING AND OTHER DRAWINGS AND SPECIFICATIONS IN THE CONSTRUCTION DOCUMENTS MUST BE REFERRED TO THE LANDSCAPE ARCHITECT PRIOR TO WORK COMMENCING.
4. THIS DRAWING MUST NOT BE COPIED IN WHOLE OR IN PART WITHOUT WRITTEN CONSENT OF LDA DESIGN.
5. THESE DRAWINGS ARE FOR FINISHES ONLY. ALL FOUNDATION, FIXING, PAVING DEPTHS AND DRAINAGE DETAILS TO BE PROVIDED BY OTHERS.
6. ALL DIMENSIONS ARE IN MM UNLESS OTHERWISE STATED.
7. WHERE DIMENSION SIZES OF UNITS ARE GIVEN THEY STATE LENGTH X WIDTH X DEPTH.

| | | | |
|------|------------------|------|----------|
| T02 | Issue for Tender | KB | 28.07.25 |
| T01 | Issue for Tender | KB | 30.05.25 |
| REV. | DESCRIPTION | APP. | DATE |

LDA DESIGN
TORBAY COUNCIL

PROJECT TITLE
Paignton and Preston Coastal Scheme

DRAWING TITLE
Paignton Furniture Layout and Reference
Sheet 01 of 05

| | | | |
|-----------|----------|------------------|----|
| ISSUED BY | Exeter | T: 01392 260 430 | |
| DATE | Nov 2024 | DRAWN | FG |
| SCALE/RA1 | 1:250 | CHECKED | KB |
| STATUS | Tender | APPROVED | RA |

DWG. NO 9730-LDA-C-PA-L-300-01

No dimensions are to be scaled from this drawing.
All dimensions are to be checked on site.
Area measurements for indicative purposes only.

© LDA Design Consulting Ltd. Quality Assured to BS EN ISO 9001 : 2015
Sources: Ordnance Survey

READ THIS FIRST



Note for Contractors

This drawing should be considered along with the risk information contained in the CDM Pre Construction Information. This information will include details of the SIGNIFICANT risks which LDA Design has identified which may arise from constructing their designs shown on this drawing. A Competent Contractor should be aware of the typical risks associated with doing this work.



Note for Workers

DO NOT START YOUR WORK unless you know the Risks and Controls relating to the work on this drawing (including SAFE SEQUENCES OF WORK and EQUIPMENT).



Do not issue copies of parts of this drawing without the above Note for Workers (unless you are sure that the Workers can undertake the work safely).